

First Annual

Gans Creek Classic

Saturday, September 28, 2019

Gans Creek Cross Country Course, Columbia, MO

Meet Directors

Erika Coffman, Columbia Parks and Recreation and Neal Blackburn, Rock Bridge High School

Course Description

- Loop course - All distances made up from the 2K loop and 3K loop
- Entire course irrigated and graded for drainage
- Minimum course width is 10 meters throughout
- Starting line accommodates up to 40 teams and 550 meters to first sweeping turn
- 2K loop includes lightly rolling hills; sweeping, graded turns
- 3K loop has common first 1200m with 2K loop
- Last 1800m of 3K loop with sweeping, graded turns with slight uphill 300m finish
- Finish straight away of 300m is slightly uphill with elevated viewing berm

Course Features

- Permanent start/finish line adjacent to medical support and athlete recovery tent
- Fully graded and irrigated
- Viewing berms
- Course fencing
- Electronic K markers
- Dedicated tent city with easy access to start/finish

Course Inspection

Course will be available Friday after 3pm (weather dependent). The course will be dedicated at 4pm with two collegiate races starting at 5pm. Race packets and meet merchandise will be available as well on Friday evening and Saturday morning. Please allow additional 15 minutes in your planning for vehicle drop-off and parking.

Race Distances

Varsity - 5,000 Meters

Junior Varsity - 5,000 Meters

List of Confirmed Schools

[List of Boys Entries](#)

[List of Girls Entries](#)

Entry Fee

\$150 per team, per gender

Entry Information

Registration will be done through mo.milesplit.com. Registration will open on Monday, August 19th and close at midnight on September 12th. Up to 10 athletes are allowed to compete in the Varsity divisions, with unlimited entries in the JV divisions.

- Set up an account if you do not have one. If you need assistance, visit [milesplit support](http://milesplit.com).
- Sometime after your official roster is submitted to MSHSAA, it will populate in mo.milesplit.com. You can view and edit roster as needed.
- On the meet calendar page you can click on the Gans Creek Classic and proceed through the official entry process. You will proceed through the provided checklist where you will be asked to choose your team, athletes, and finalize your athlete entries.

Payment Information

Payment is due by Friday, September 20.

- Visa, Mastercard Payment Contact Lida Gochenour at 573-874-7719
- Make checks payable to Columbia Parks and Recreation
% Erika Coffman
P.O. Box 6105
Columbia, MO 65205

Box Assignments

Box assignments will be drawn a week prior to the meet and updated on the website. Right now, divisions will be either based on your preference, school size, or competitiveness. School interest will help determine final race declarations.

Schedule of Events

6am	Course Open/Packet Pick-Up
7am	Trainer On Duty
7:55am	National Anthem
8am	White Division Girls Varsity 5K Race
8:30am	White Division Boys Varsity 5K Race
9am	Blue Division Girls Varsity 5K Race
9am	Varsity White Division Awards
9:30am	Gold Division Girls Varsity 5K Race
10am	Blue Division Boys Varsity 5K Race
10:30am	Varsity Blue Division Awards
10:30am	Gold Division Boys Varsity 5K Race
11am	Varsity Gold Division Awards
11am	Blue/White Divisions Girls JV 5K Race
11:30am	Gold Division Girls JV 5K Race
12pm	Blue/White Divisions Boys JV 5K Race
12:30pm	Gold Division Boys JV 5K Race
1pm	JV Blue/White/Gold Division Awards

*Division Note: Gold is the most competitive, followed by blue and finally white.

*If heat poses a threat to athlete safety, we reserve the right to shorten the JV race distances.

Inclement Weather Policy

Meet organizers reserve the right to alter or cancel the meet due to inclement weather in the case that we deem conditions to be unsafe to compete or complete a given event. In general, we will follow the MSHSAA weather policy. In the case of lightning, we will delay the start of any event until 30 minutes after the last sighting of lightning. In the case of extreme heat, the event and the remaining races will be canceled if the heat index reaches 105 degrees. Race committee will begin to alter race distances if the heat index reaches 95 degrees or we deem conditions to be unsafe to complete the advertised distance.

Results/Timing

PrimeTime Timing will be used to time the races. Live results will be made available [online](#) and be posted following each race; www.pttiming.com.

Awards

Varsity and Junior Varsity (Champion and Runner-Up) team awards along with top 25 in each division.

Trainers

Trainers will be on duty at 7:00am in the tent (behind the finish line).

Accommodations

Stoney Creek Inn - 2601 S. Providence Rd, Columbia, MO 65203 ~ 573.442.6400

TownePlace Suites - 4400 Nocona Pkwy, Columbia, MO 65201 ~ 573.817.0012

Parking Information

Parking is free for this event and there will be no admission fee. Attached is a [map](#) that identifies all lots for schools and spectators. This is a big meet so please plan accordingly.

- School Busses - The Crossing Church
- School Mini-Busses, Vans and Cars - North Lot Gans Creek Recreation Area
- Spectators

Restricted Lot	North Lot Gans Recreation Area (ADA permit required)
P1 & P2	Philips Lake Park Lot (walking distance)
P3	Father Tolton High School (walking distance)
P4 & P5	IDEXX BioAnalytics and Eurofins BioPharma Product Testing (shuttle) *4011 Discovery Drive
P6 & P7	Discovery Office Park (shuttle) *4251 Philips Farm Road

Concessions

We will have a wide variety of food, snacks and drinks at our concession stands.

Apparel

Meet apparel will be available Friday during course review, as well as Saturday morning.

Questions

For questions, please contact Erika Coffman at Erika.Coffman@como.gov.

Gans Creek Boys' Divisions - 2019

Gold	Varsity Box	JV Box	Blue	Varsity Box	JV Box (Blue/White Combined)	White	Varsity Box	JV Box (Blue/White Combined)
Blue Springs	28	1	Branson	28		Affton	28	1
Bolivar	17	2	CBC	17	4/5	Alton	17	
Festus	20	3	Collegiate Medicine and Bioscience	21		Aurora	20	
Fort Zumwalt West	8	4	East Newton	20	7	Blair Oaks	8	
Francis Howell	23	5	Eureka	8	8	Bowling Green	24	2
Fulton School of St. Albans	36		Excelsior Springs	23	9	California	23	3
Grain Valley	27	6	Fatima	27	10	Centralia	27	6
Grandview	2	7	Fort Osage	2		Chadwick	2	
Helias	13	8	Fort Zumwalt North	13	11	Christian Fellowship	13	
Herculeum	15	9	Fort Zumwalt South	15	12	Christian	15	
Hickman	14	10	Fox	14		Couch	14	
Jackson	32	11	Hermann	32	13	Fulton	32	
Joplin	4		John Burroughs	4		Grandview R-2	4	37
Kearney	5	12	Kirksville	5	14	Hannibal	5	
Kirkwood	9	13	Lamar	7	16	Holden	9	
Ladue	34	24	Smithville	11	31	Jefferson (Festus)	7	
Lafayette (Wildwood)	7		Lebanon	19		St. Paul Lutheran	11	
Lee's Summit North	11		Lexington	16	17	Knob Noster	19	
Lee's Summit West	19	14	Liberty (Wentzville)	22	18	Lafayette C-1	16	
Liberty	16	15	Lutheran St. Charles	31		Linn	22	
Liberty North	22	16	Mehlville	12		Lutheran North	31	
Lindbergh	31	17	MICDS	25		Lutheran South	12	
Marquette	12		Muriel Battle	1		Maplewood Richmond Heights	25	
Notre Dame	35		Northwest R-1	30		Marion County R-2	1	
Park Hill South	25		Notre Dame		22	Meadow Heights	30	
Parkway Central	1	24	Oak Park	29		Moberly	21	19
Parkway South	30	18	Owensville	33	24	Montgomery County	29	
Raymore-Peculiar	21	19	Pacific	3	25	New Bloomfield	33	20
Rock Bridge	29	20	Park Hill	6	26	New Haven	3	21
Rockhurst	33	21/22	Pleasant Hill	10	27	North Callaway	6	
Rockwood Summit	3		Potosi	18	28	Northeast R-IV	10	
St. Joseph Central	6		Principia	24	29	Palmyra	18	
Staley	10		Priory	9		Reeds Spring	26	
Timberland	18		Raytown	26		Southern Boone	34	
Webb City	24		Southwest (Moberly)	34	32	Sullivan	35	33
Webster Groves	26	23	Spokane	35		Valle Catholic	36	34
			St. Charles West	36		Versailles	37	
			Steelville	37		Whitfield	38	36
			Union	38	35			
			Westminster Christian Academy	39	23			
			Mexico	40				

Gans Creek Girls' Divisions - 2019

Gold Division	Varsity Box	JV Box	Blue Division	Varsity Box	JV Box (Blue/White Combined)	White Division	Varsity Box	JV Box (Blue/White Combined)
Blue Springs	13		Blair Oaks	13		Affton	13	
Bolivar	15	25	Bowling Green	34	2			
Branson	22		Brookfield	26		Spokane	22	
Cor Jesu Academy	34		Centralia	9	4	Alton	34	
Eureka	26	1	Excelsior Springs	16	5	Aurora	26	
Fatima	9		Fort Osage	24		Southern Boone	9	
Festus	16	2	Fort Zumwalt North	36	6	California	16	3
Fort Zumwalt South	24	3	Fox	27		Christian Fellowship	24	
Fort Zumwalt West	40	24	Grandview	17	8	Christian HS	36	
Francis Howell	36	7 Combined Div*	Hannibal	14		East Newton	27	
Grain Valley	27	4	Hermann	15	10	St. Joseph Christian	17	
Helias	17	5	Incarinate Word	20	11	Grandview R2	15	30
Herculaneum	14		Joplin	4		St. Paul Lutheran	20	24
Hickman	15	6	Kearney	25	13	Harrisburg	7	9
Jackson	39	23	Lebanon	10		Holden	4	
John Burroughs	20		Lutheran South	18		Jefferson (Festus)	25	
Kirkwood	7	7	Mehlville	11		Knob Noster	18	
Ladue	4	8	MICDS	8		Lafayette C1	11	
Lafayette (Wildwood)	25		Muriel Battle	32		Lamar	8	
Lee's Summit North	10		New Bloomfield	1		Lexington	32	
Lee's Summit West	18	9	New Haven	2		Linn	1	
Liberty	11	10	North Callaway	3		Lutheran (St. Charles)	2	
Liberty (Wentzville)	8	11	Northwest R1	6		Lutheran North	3	
Liberty North	32	12	Oak Park	5		Reeds Spring	38	
Lindbergh	1	13	Pacific	19	17	Steelville	5	
Marquette	2		Park Hill	28	18	Maplewood Richmond Heights	19	
Nerinx Hall	3		Parkway Central	30	19	Valle	28	25
Notre Dame	38	14	Potosi	37	21	Marion County R2	30	15
Owensville	5	15	Raytown	23	23	Meadow Heights	37	
Park Hill South	19		St. Charles West	33		Moberly	23	
Parkway South	28	16	Union	35		Sullivan	33	31
Parkway West	30	17	Visitation	31	26	Northeast R-IV	35	
Raymore-Peculiar	37	18	Webster Groves	29		Montgomery County	31	
Rock Bridge	23	19	Westminster Christian Academy	21	28	Palmyra	29	
Rockwood Summit	33	20	Kirksville	38	14	Pleasant Hill	21	20
Smithville	35	21	Fulton	39		Principia	40	22
St. Joe Central	31		Mexico	40	16	Versailles	10	
St. Teresa's Academy	29	22				Villa Duchesne	14	
Staley	21					Whitfield	39	29
Timberland	12							
Webb City	6							

9/26/2019

FIRST ANNUAL GANS CREEK *Classic* 2019

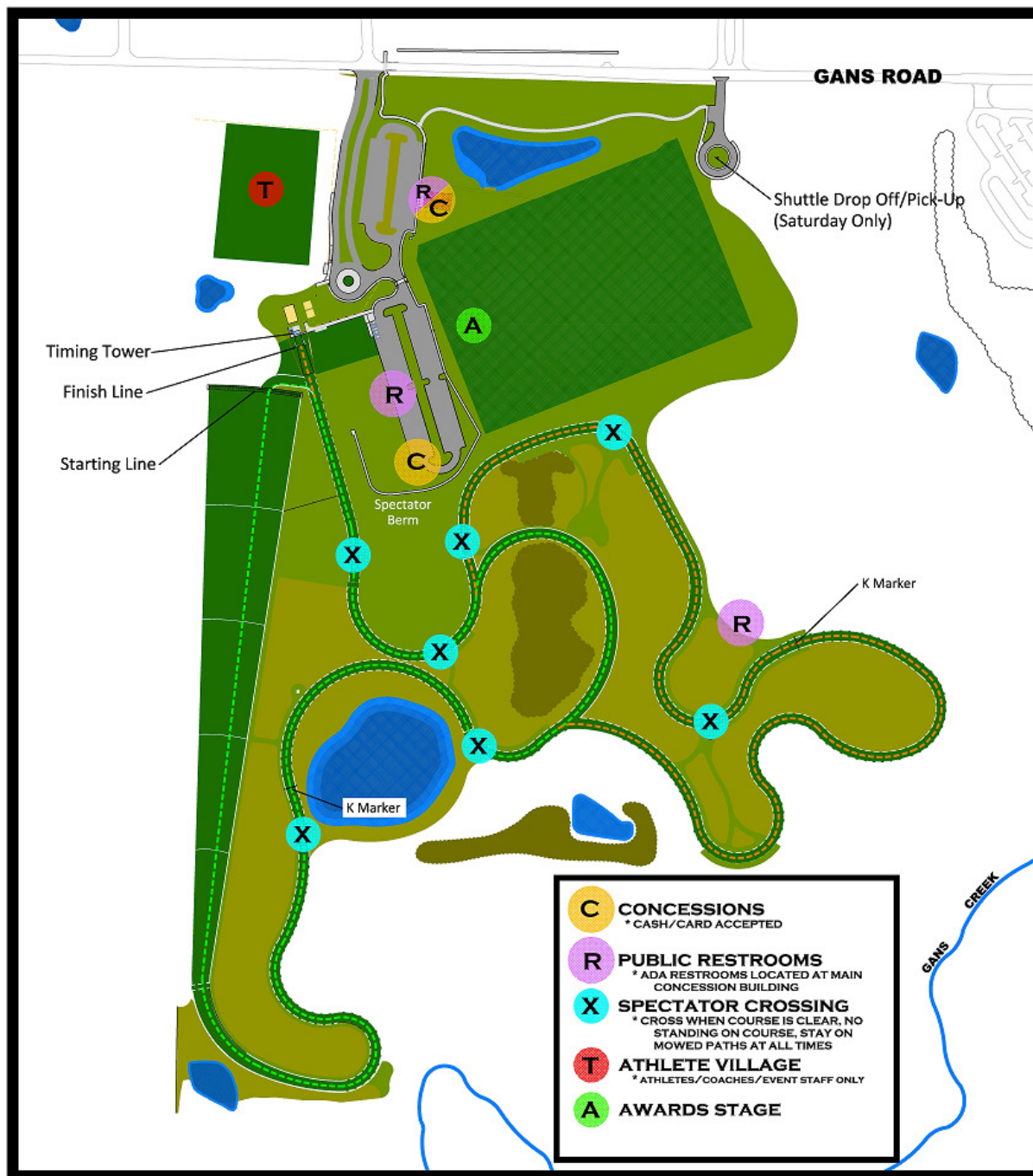

EVENT MAP GANS CREEK RECREATION AREA



FIRST ANNUAL GANS CREEK *Classic* 2019

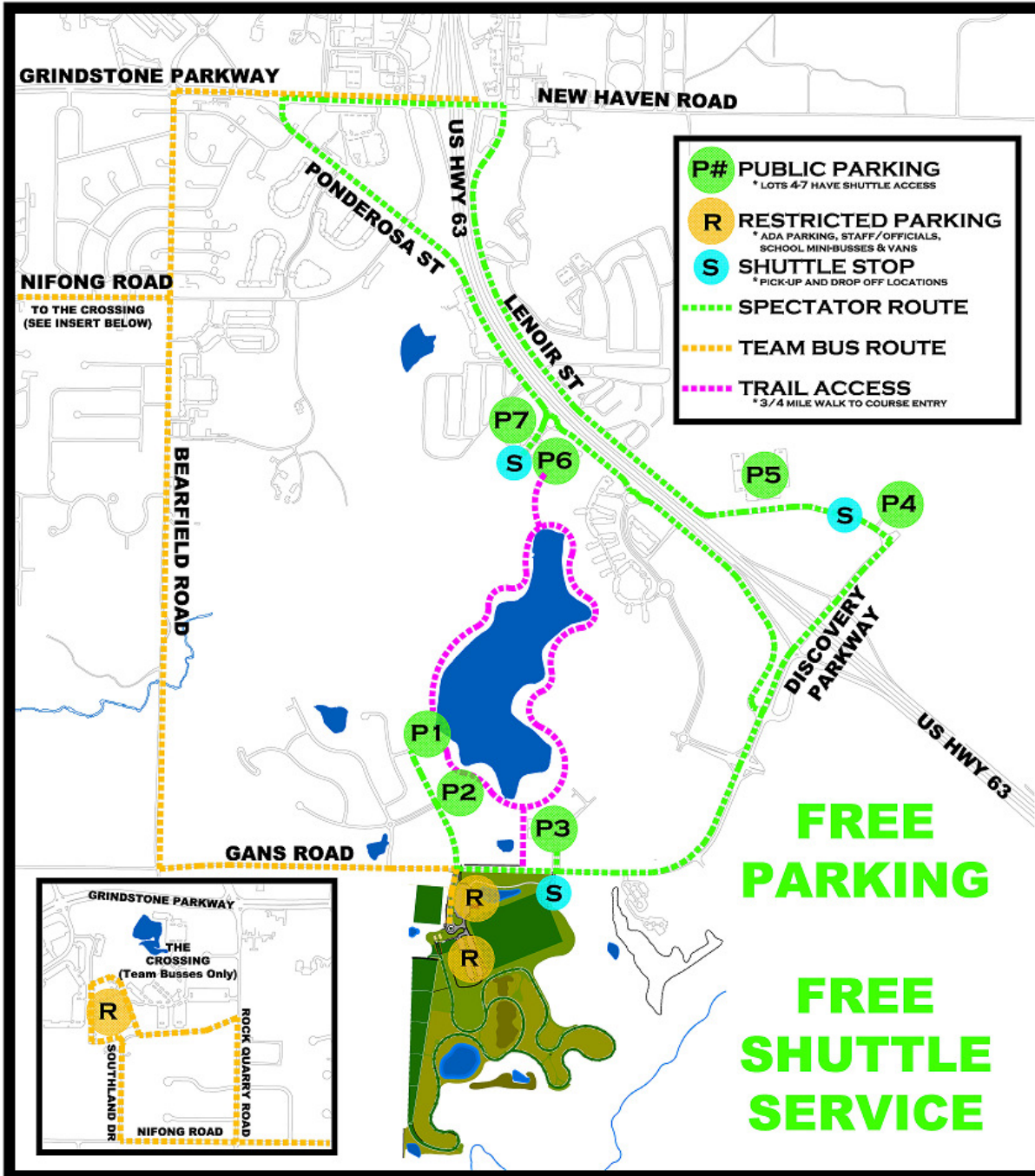

SATURDAY EVENT - PARKING MAP GANS CREEK RECREATION AREA

