

City of Columbia

701 East Broadway, Columbia, Missouri 65201



Agenda Item Number: B 215-14

Department Source: Public Works

To: City Council

From: City Manager & Staff

Council Meeting Date: July 21, 2014

Re: Ash Street - No Parking, Tow-Away Zone

Documents Included With This Agenda Item

Council memo, Resolution/Ordinance

Supporting documentation includes: Maps

Executive Summary

Amending Chapter 14 of the City Code of Ordinances to establish a “no parking, tow-away zone” on a portion of Ash Street, near College Avenue; and setting a minimum fine for parking in a “no parking, tow-away zone”.

Discussion

Staff was recently contacted concerning vehicles parking on both sides of Ash Street, near College Avenue, causing difficulty for vehicles traveling in opposite directions to progress easily. Ash Street is 27 feet wide, and the curbs on both sides of the street are painted yellow from College Avenue to a point roughly 100 feet west thereof. In this area, vehicles are parking against the yellow painted curbs.

Staff contacted the Columbia Fire and Police departments regarding this issue. The Police department is currently ticketing vehicles parked against the yellow curb, per Section 14-286. The Fire department commented that when vehicles are parked against the yellow curb, there is not adequate space for their vehicles to function on Ash Street. Therefore, staff recommends amending Section 14-304 of the Code of Ordinances to designate a “no parking, tow-away zone” on the north side of Ash Street, from College Avenue to a point 100 feet west thereof, and on the south side of Ash Street, from Saint Joseph Street to College Avenue.

Staff also recommends setting the minimum fine for parking in a “no parking, tow-away zone” at \$100.00.

Fiscal Impact

Short-Term Impact: Estimating \$225 for signage

Long-Term Impact: None

Vision, Strategic & Comprehensive Plan Impact

Vision Impact: Transportation

Strategic Plan Impact: Not Applicable

Comprehensive Plan Impact: Not Applicable

City of Columbia

701 East Broadway, Columbia, Missouri 65201



Suggested Council Action

Authorize an amendment to Section 14-304 to establish a "no parking, tow-away zone" on the north side of Ash Street, from College Avenue to a point 100 feet west thereof, and on the south side of Ash Street, from Saint Joseph Street to College Avenue; and setting a minimum fine of \$100 for parking in a no parking, tow-away zone.

Legislative History

None



Department Approved

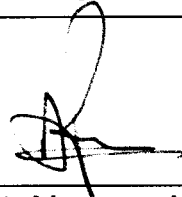

City Manager Approved

Introduced by _____

First Reading _____

Second Reading _____

Ordinance No. _____

Council Bill No. B 215-14

AN ORDINANCE

amending Chapter 14 of the City Code to restrict parking along portions of Ash Street, and setting a minimum fine for parking in restricted areas and tow-away zones; and fixing the time when this ordinance shall become effective.

BE IT ORDAINED BY THE COUNCIL OF THE CITY OF COLUMBIA, MISSOURI, AS FOLLOWS:

SECTION 1. Chapter 14 of the Code of Ordinances of the City of Columbia, Missouri, is hereby amended as follows:

Material to be deleted in ~~strikeout~~; material to be added underlined.

Sec. 14-304. No parking, tow-away zones.

(a) When signs are placed, erected or installed giving notice thereof, no person shall stop, stand or park a vehicle upon any of the streets or places hereinafter set forth:

Ash Street, north side, beginning at the west curb of College Avenue thence west one hundred (100) feet.

Ash Street, south side, from Saint Joseph Street to College Avenue.

I-70 Drive Southeast, both sides, beginning two thousand (2,000) feet east of Woodridge Drive, thence east six hundred (600) feet.

Rollins Street, both sides, beginning one hundred twenty-five (125) feet from the west curb of Hitt Street and ending 485 feet from the east curb of Missouri Avenue.

Any roadway signed as a snow route when there is two (2) inches or more of snow on the roadway.

(b) Vehicles in violation of this section shall be towed.

(c) Every person convicted of a violation of any of the provisions of this section shall be punished as provided in section 1-8 of this Code, except that a fine shall not be less than one hundred dollars (\$100.00).

SECTION 2. This ordinance shall be in full force and effect from and after its passage.

PASSED this _____ day of _____, 2014.

ATTEST:

City Clerk

Mayor and Presiding Officer

APPROVED AS TO FORM:

City Counselor

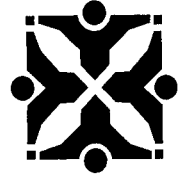

SUPPORTING DOCUMENTS INCLUDED WITH THIS AGENDA ITEM ARE AS FOLLOWS:

Maps

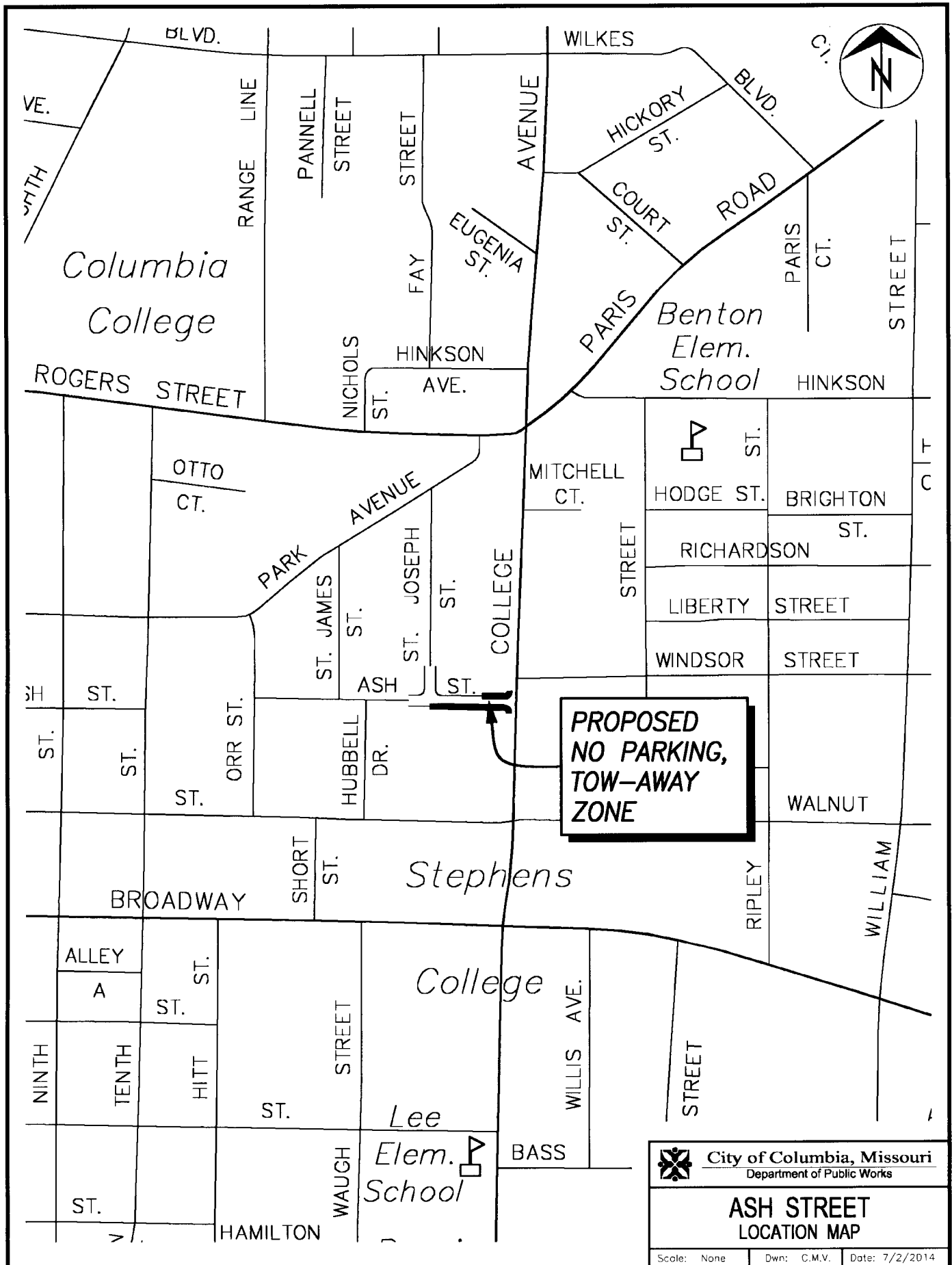

**PROPOSED
NO PARKING,
TOW-AWAY
ZONE**

 City of Columbia, Missouri Department of Public Works		
ASH STREET LOCATION MAP		
Scale: None	Dwn: C.M.V.	Date: 7/2/2014