

# City of Columbia

701 East Broadway, Columbia, Missouri 65201



**Agenda Item Number:** B 185-15

**Department Source:** Public Works

**To:** City Council

**From:** City Manager & Staff

**Council Meeting Date:** 7/06/2015

**Re:** Fay Street Parking Restriction

## Documents Included With This Agenda Item

Council memo, Resolution/Ordinance

**Supporting documentation includes:** Map, Correspondence from the public and City staff

## Executive Summary

Authorizing an amendment to Chapter 14 of the City Code to prohibit parking along a portion of Fay Street at all times. Staff recommendation is to restrict parking on the east side of the street from Hinkson Avenue to a point 250 feet north thereof.

## Discussion

In January of 2015, staff received a request to address parking issues along Fay Street just north of Hinkson Avenue, due to access issues while vehicles are parked on the street. Fay Street is approximately 21 to 22 feet wide in this area and there are currently no parking restrictions on the street. Staff contacted the Fire Department regarding access, and their field inspection concluded that if vehicles are parked in front of the Woodruff Switzer building (Historic Mule Barn), it would compromise emergency access to that building (see attached e-mail).

In February of 2015, staff sent a letter to property owners along Fay Street, from Hinkson Avenue to the COLT Railroad, seeking feedback concerning a possible parking prohibition on the street. Following is a summary of the responses received from property owners. The letter from staff and responses from the property owners are attached.

5 - do not restrict parking;

1 - restrict parking on both sides from Hinkson Avenue to the COLT Railroad;

3 - restrict parking on the east side from Hinkson Avenue to the COLT Railroad;

1 - restrict parking on a portion of the east side from Hinkson Avenue to the COLT Railroad;

2 - restrict parking on a portion of both sides from Hinkson Avenue to the COLT Railroad;

1 e-mail response received is from the same address as a survey response.

Due to the responses received, staff recommends restricting parking on the east side of Fay Street from Hinkson Avenue to a point 250 feet north thereof; and to address the Fire Department's concern, staff has painted a 15 ft section of curb on on each side of an FDC fire connection, on the west side of Fay Street.

# City of Columbia

701 East Broadway, Columbia, Missouri 65201



## Fiscal Impact

Short-Term Impact: \$200 from the Street Maintenance budget for materials.

Long-Term Impact: Sign replacement as needed.

## Vision, Strategic & Comprehensive Plan Impact

Vision Impact: Transportation

Strategic Plan Impact: Customer Focused Government

Comprehensive Plan Impact: Not Applicable

## Suggested Council Action

If council concurs with staff recommendation to prohibit parking along the East side of Fay Street from Hinkson Avenue to a point 250 feet north thereof at all times, pass the ordinance amending Chapter 14 of the City Code.

## Legislative History

None

  
Department Approved

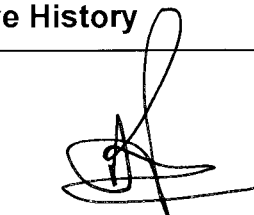
  
City Manager Approved

Introduced by \_\_\_\_\_

First Reading \_\_\_\_\_

Second Reading \_\_\_\_\_

Ordinance No. \_\_\_\_\_

Council Bill No. B 185-15

### AN ORDINANCE

amending Chapter 14 of the City Code to prohibit parking on a portion of the east side of Fay Street; and fixing the time when this ordinance shall become effective.

BE IT ORDAINED BY THE COUNCIL OF THE CITY OF COLUMBIA, MISSOURI, AS FOLLOWS:

SECTION 1. Chapter 14 of the Code of Ordinances of the City of Columbia, Missouri, is hereby amended as follows:

Material to be deleted in ~~strikeout~~; material to be added underlined.

Sec. 14-324. Parking prohibited.

When signs are placed, erected or installed in each block, giving notice thereof, no person shall park a vehicle upon any of the streets or places hereinafter set forth:

. . .

*Fay Street*, east side, between Wilkes Boulevard and Smith Street.

*Fay Street*, east side, from Hinkson Avenue, thence north two hundred fifty (250) feet.

*Fellows Place*, south and east side, from Rock Quarry Road for its entire length.

. . .

SECTION 2. This ordinance shall be in full force and effect from and after its passage.

PASSED this \_\_\_\_\_ day of \_\_\_\_\_, 2015.

ATTEST:

\_\_\_\_\_  
City Clerk

\_\_\_\_\_  
Mayor and Presiding Officer

APPROVED AS TO FORM:

\_\_\_\_\_  
City Counselor



## SUPPORTING DOCUMENTS INCLUDED WITH THIS AGENDA ITEM ARE AS FOLLOWS:

Map, Correspondence from the public and City staff

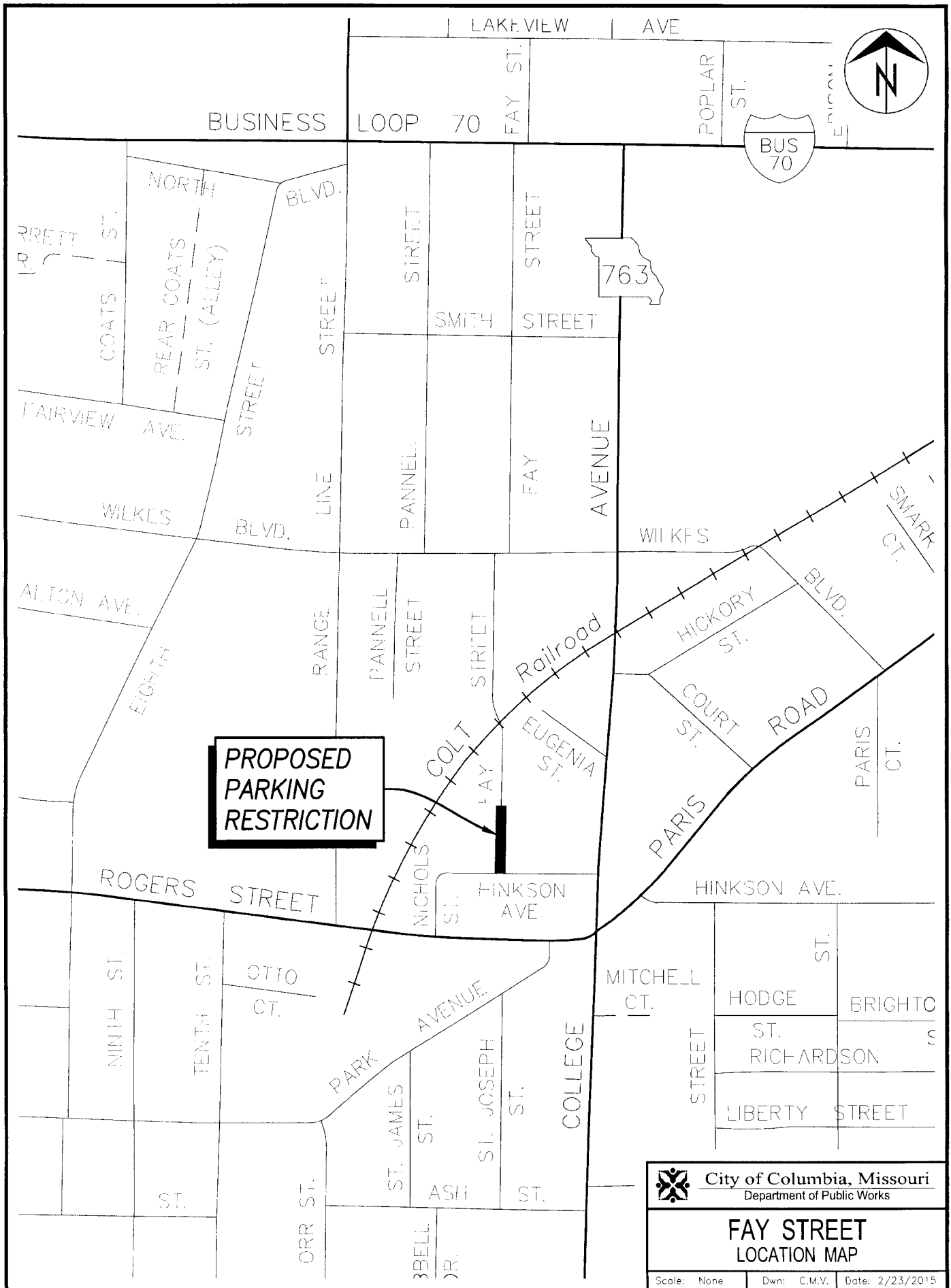



Chris Valleroy &lt;cmvaller@gocolumbiamo.com&gt;

---

**Fwd: Fay Street parking**

1 message

**Brad Fraizer** <blfraize@gocolumbiamo.com>

Fri, Feb 13, 2015 at 8:04 AM

To: Chris Valleroy &lt;cmvaller@gocolumbiamo.com&gt;

Cc: "Jenkins, Jerry" &lt;jlj@gocolumbiamo.com&gt;, "Warren, Gary" &lt;gww@gocolumbiamo.com&gt;, "White, Randall" &lt;rew@gocolumbiamo.com&gt;, "Hudson, Matt" &lt;jnh@gocolumbiamo.com&gt;, Richard Stone &lt;rlstone@gocolumbiamo.com&gt;

Chris

Please note the e-mail below and attached photographs regarding Fay Street and let us know if there is anything else we can provide.

Thank you

----- Forwarded message -----

From: **Brian Tilman** <bkt@gocolumbiamo.com>

Date: Thu, Feb 12, 2015 at 5:54 PM

Subject: Re: Fay Street parking

To: Gary Warren &lt;gww@gocolumbiamo.com&gt;, "Jenkins, Jerry" &lt;jlj@gocolumbiamo.com&gt;, "Fraizer, Brad" &lt;blfraize@gocolumbiamo.com&gt;

Chief's,

I was asked by Chief Warren to evaluate the access situation on Fay street as concerned above.

It is my opinion that due to the size of the street and our apparatus that we would not be able to safely operate the outriggers on our aerial device such as Ladder One. If possible, I feel it would be best to remove the parking spaces on the West side of the road directly in front of the Wodruff Switzer building. This would allow our apparatus better access in an emergency.

In addition restricting parking in front of the building will also open the access to the FDC located in front of the building. As you can see in the picture below with the current parking gaining access to the FDC could be troublesome.

Respectfully,

Captain Brian Tilman

On Thu, Feb 12, 2015 at 3:58 PM, Gary Warren <gww@gocolumbiamo.com> wrote:

----- Forwarded message -----

From: **Brad Fraizer** <blfraize@gocolumbiamo.com>

Date: Thu, Feb 12, 2015 at 12:46 PM

Subject: Fwd: Fay Street parking

To: "Jenkins, Jerry" &lt;jlj@gocolumbiamo.com&gt;, "Warren, Gary" &lt;gww@gocolumbiamo.com&gt;

Cc: "Hudson, Matt" &lt;jnh@gocolumbiamo.com&gt;, "White, Randall" &lt;rew@gocolumbiamo.com&gt;

Chief Jenkins

Would a crew be able to drive to this location, photograph the area in question with the truck in the roadway and offer their opinion on access if parking is not restricted?

Thank you

----- Forwarded message -----

From: **Chris Valleroy** <cmvaller@gocolumbiamo.com>

Date: Thu, Feb 12, 2015 at 10:49 AM

Subject: Fay Street parking

To: Brad Fraizer <blfraize@gocolumbiamo.com>

Cc: Richard Stone <rlstone@gocolumbiamo.com>

We have been informed of a parking concern by a citizen on Fay Street just north of Hinkson Avenue, more specifically between Logboat Brewing Co & Woodruff Switzer. The width of Fay Street at this location is about 22 feet. Currently there are no parking restrictions per city ordinance in this area, however there is a loading zone on the west side of Fay Street from Hinkson Avenue to a point about 70 feet north thereof. We are considering restricting parking on Fay Street in this area. We would be interested to know if your crews have had any past issues getting a fire truck down that street while vehicles are parked on the street or if your crew could sometime in the near future drive a fire truck down that street while vehicles are parked on the street and give us some feedback on what they think. Any thoughts or recommendations you may have would be much appreciated. Thanks.

—

Chris M. Valleroy  
Sr. Engineering Technician  
City of Columbia, Missouri  
Public Works Engineering  
573-874-6361

—

**Battalion Chief Brad Fraizer, CFI, CTA**  
**Fire Marshal and Public Information Officer**  
**Columbia Missouri Fire Department**  
**201 Orr Street**  
**Columbia, MO 65201**  
**(573) 874-7557 office**  
**(573) 268-0438 cell**  
**(573) 499-7035 media pager**  
[www.GoColumbiaMo.com/Fire/](http://www.GoColumbiaMo.com/Fire/)

—

Gary L. Warren, Jr.  
Battalion Chief / Emergency Services Division  
Columbia Missouri Fire Department  
[GWW@GoColumbiaMo.com](mailto:GWW@GoColumbiaMo.com)  
(573) 874 - 7440 Office  
(573) 219 - 0475 Cell

--

**Battalion Chief Brad Fraizer, CFI, CTA**

**Fire Marshal and Public Information Officer**  
**Columbia Missouri Fire Department**  
201 Orr Street  
Columbia, MO 65201  
(573) 874-7557 office  
(573) 268-0438 cell  
(573) 499-7035 media pager  
[www.GoColumbiaMo.com/Fire/](http://www.GoColumbiaMo.com/Fire/)

---

**4 attachments**



**IMG\_3281.JPG**  
140K



**IMG\_3283.JPG**  
127K



**IMG\_3285.JPG**  
126K



**IMG\_3286.JPG**  
123K





## CITY OF COLUMBIA, MISSOURI

PUBLIC WORKS DEPARTMENT

February 27, 2015

To Whom It May Concern:

This letter is to provide information that the Public Works Department is considering recommending that City Council pursue prohibiting parking along a portion of Fay Street from Hinkson Avenue to the COLT Railroad. We are asking for owners and residents along Fay Street in this area to provide staff with comments regarding this proposed restriction.

This request for comments has been initiated due to citizen contact indicating concerns with limited ability to drive along Fay Street just north of Hinkson Avenue with parking present of the street.

There is no current parking restriction per city ordinance on Fay Street from Hinkson Avenue to the COLT Railroad. There is a loading zone on the west side of Fay Street from Hinkson Avenue to a point about 70 feet north thereof.

Based on Public Works staff evaluation of the street and with consultation from Fire Department personnel, staff believes that a parking prohibition along a portion of the east or west side of Fay Street from Hinkson Avenue to the COLT Railroad at all times may be appropriate. We are seeking input regarding parking along the street.

Please provide us with information regarding this potential change. If you have comments, please fill out the 3 question online survey at: <http://tinyurl.com/mengfty> or send a written correspondence by March 20, 2015 to:

City of Columbia - Missouri  
Public Works Department  
Attn: Chris Valleroy  
PO Box 6015  
Columbia, MO 65205

If you have questions, please contact Mr. Chris Valleroy at 573-874-7250 or [cmvaller@gocolumbiamo.com](mailto:cmvaller@gocolumbiamo.com)

Respectfully,

A handwritten signature in black ink, appearing to read "Richard L. Stone II".

Richard L. Stone II, P.E.  
Traffic Engineering Supervisor

# Fay Street Parking Restriction

Please provide information to help Public Works Staff in determining if any parking restriction should be applied and if so, where it should be located. Currently there are no parking restrictions on Fay Street from Hinkson Avenue to the COLT Railroad.

\* Required

## 1. Address \*

What is your address?

## 2. Please check the boxes that reflect your view of parking on Fay Street

*Check all that apply.*

- ☐ I think parking should be allowed on both sides of Fay Street from Hinkson Avenue to the COLT Railroad at all times.
- ☐ I think parking should be prohibited on both sides of Fay Street from Hinkson Avenue to the COLT Railroad.
- ☐ I think parking should be prohibited on the east side of Fay Street from Hinkson Avenue to the COLT Railroad.
- ☐ I think parking should be prohibited on the west side of Fay Street from Hinkson Avenue to the COLT Railroad.
- ☐ I think parking should be prohibited on a portion of the east side of Fay Street from Hinkson Avenue to the COLT Railroad.
- ☐ I think parking should be prohibited on a portion of the west side of Fay Street from Hinkson Avenue to the COLT Railroad.
- ☐ I think parking should be prohibited on a portion of both sides of Fay Street from Hinkson Avenue to the COLT Railroad.

## 3. Please provide any additional information you feel is necessary

Write freely to express your opinion on prohibiting parking along Fay Street

Powered by

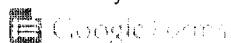

## Fay Street Parking Restriction (Responses)

Timestamp	Address	Please check the boxes that reflect your view of parking on Fay Street	Please provide any additional information you feel is necessary	Source	Additional
3/2/2015	504 Fay Street	I think parking should be prohibited on a portion of both sides of Fay Street from Hinkson Avenue to the COLT Railroad.	Logboat would be open to a conversation regarding the removal of the sidewalk along the east side of Fay to put in 45 degree parking. We paid to have the sidewalk installed per city ordinance during construction of our building, but we would suggest being compensated for the expense of putting in the sidewalk (I believe that expense was less than \$15,000) and have the city pay to put in permanent parking solutions. Very few people use the east sidewalk, and it ends with a utility pole right in the middle of it. If people need a sidewalk there is one on the west side of Fay, and all ADA needs have been met with our existing sidewalk. Just a thought, might not be feasible however. The current parking situation on Fay is problematic to say the least, and we are always available for conversation and shared problem solving. Thanks!	Survey	Also received email from Gardell Powell at this address
3/3/2015	501 Fay Street Suite 102	I think parking should be allowed on both sides of Fay Street from Hinkson Avenue to the COLT Railroad at all times.		Survey	
3/4/2015	505 Fay Street #101	I think parking should be prohibited on a portion of the east side of Fay Street from Hinkson Avenue to the COLT Railroad.	I have lived at this address for several years (and therefore have the perspective of how the street was prior to Log Boat Brewery moving in). Parking along the west side of the street along our apartment building has never been a problem. It is very convenient for tenants of both the apartment section and business section to have access from the west entrance (as not everyone has access from the ground floor/individual doors on the north side of the apartment section). What has been a problem is that there is no clear signage restricting parking along the east side of the street/on the brewery side. There have been times (especially in the summer) when brewery customers have parked on this side of the street causing the street to restrict to one-lane. This problem could easily be alleviated by restricting parking on the east portion of the street along the 100 yards of street by the brewery. Thank you for your consideration and for addressing this problem.	Survey	
3/4/2015	505 fay st. apt 102	I think parking should be allowed on both sides of Fay Street from Hinkson Avenue to the COLT Railroad at all times.		Survey	
3/5/2015	501 Fay Ste. 106	I think parking should be allowed on both sides of Fay Street from Hinkson Avenue to the COLT Railroad at all times.		Survey	
3/5/2015	501 Fay St.	I think parking should be allowed on both sides of Fay Street from Hinkson Avenue to the COLT Railroad at all times.	The placement of a side walk on the east side of fay st that goes from nowhere to nowhere but takes up what used to be useful parking space and has turned a navigable portion of the street into an obstacle was a foolish endeavor. The sidewalk should be removed and this will solve any issues. There is not enough parking for this area to begin with. If restrictions are put in place on fay, then Nichols St. should be designated as parking for the use of business in this area and not for use by Columbia College students or anyone not doing business or working here.	Survey	
3/5/2015	501 fay st		While i do not think parking should be prohibited on either side of fay st, as this would create a parking problem for tenants and employees of Fay st building, it would be nice if there were mirrors on the telephone poles at the intersection of Fay and Hinkson and on Fay st where the Fay st lofts parking lot exits, as it is very hard to see other cars driving down the street when pulling out of the parking lot on to fay st and turning on to hinkson off of fay st.	Survey	

## Fay Street Parking Restriction (Responses)

Timestamp	Address	Please check the boxes that reflect your view of parking on Fay Street	Please provide any additional information you feel is necessary	Source	Additional
3/5/2015	501 Fay St, #106	I think parking should be prohibited on the east side of Fay Street from Hinkson Avenue to the COLT Railroad.	I own/operate a business out of the old Fay St. Building at the corner of Hinkson and Fay. My business has had an office in the building since the fall of 2010. Cars parked freely on both sides of the road north of Hinkson on Fay St. until the city required the addition of a sidewalk on the east side of the road when Log Boat Brewing went in. Since then, parking has completely ceased on the east side of the road. I wish the sidewalk was gone and we had all the spots back from the east side of the street, but at this point I would like to at least see the spots on the west side of the road stay. I would like to see one or two spots on the south side of the building going west from Fay St. be marked as no parking so traffic turning from Fay onto Hinkson can see if anyone is coming from the west. Other than that, I haven't seen any problems with parking on the streets around the Fay St. Building.	Survey	
3/5/2015	501 Fay St., Ste 210	I think parking should be prohibited on the east side of Fay Street from Hinkson Avenue to the COLT Railroad.	With parking for our employees and clients in our parking lot at 501 Fay St being so limited, having those additional Fay St. spots on the west side of Fay is crucial.	Survey	
3/9/2015	602 Fay St.	I think parking should be prohibited on a portion of both sides of Fay Street from Hinkson Avenue to the COLT Railroad.	Specifically, the area marked "proposed" on the enclosed map is where parking should be prohibited.	Survey	
3/12/2015	600 fay street apt b	I think parking should be prohibited on both sides of Fay Street from Hinkson Avenue to the COLT Railroad.	The road through this area is so narrow that when people are parked along one side of the road, it is very hard to drive through with a trailer. Most of the business through this area use trailers including mine on a daily bases, so this makes it nearly impossible to drive through this area.	Survey	
3/20/2015	501 Fay St, Ste 110	I think parking should be prohibited on the east side of Fay Street from Hinkson Avenue to the COLT Railroad.	I am an employee of a business located in The Historic Mule barn building. The owner has created additional parking in the back lot, however, parking remains to be a challenge. I believe it is imperative that parking along the west side of Fay Street remain as is, with the loading area marked. Parking on one side only allows for traffic to flow through. I am speaking on behalf of 23 employees.	Survey	
3/18/2015	504 Fay Street		Email is attached to this report	Email	Email from Gardell Powell



Chris Valleroy <cmvaller@gocolumbiamo.com>

## prohibiting parking along Fay Street

1 message

Gardell Powell <gardell@veteransunited.com>

Wed, Mar 18, 2015 at 4:20 PM

To: "cmvaller@gocolumbiamo.com" <cmvaller@gocolumbiamo.com>

Mr. Valleroy,

I received the letter from Richard Stone regarding the proposal to prohibit parking along Fay Street from Hinkson Ave. I attempted to fill out the on-line survey twice but have not been able to access the resource.

I am opposed to the recommendation as this will cause further congestion with parking in the surrounding areas. I am the landlord at 504 Fay Street (Logboat Brewing Co) and was required to install a sidewalk on the east side of Fay Street during construction. Although that was costly and likely satisfies the appropriate code it does make that lane narrow when cars park along the west side of the road. The newly constructed sidewalk is rarely used and in fact leads directly into a telephone pole. My concern is that removing those spots will cause people to park illegally at other businesses or even in private parking spaces, which could lead to additional towing complaints. I do not know the motivation behind the recommendation or if there have been complaints but I am certainly interested in being a part of proposed solutions. I would not be surprised if this proposal was adopted that you would receive far more complaints regarding parking.

Sincerely,

Justin Gardell Powell

White Oak Investment Properties, LLC

NMLS 1907

Our company is an Equal Opportunity Lender.

Our company is a VA approved lender, but we are not affiliated with any government agency.

NOTICE Regarding Identity Protection: For our clients' protection and confidentiality, we at Mortgage Research Center, LLC want to remind you that Internet e-mail is not a secure medium, and is not intended for sending confidential or sensitive personal information. Please do not include your social security number, account numbers, or any other personal or financial information as an attachment or in the content of your email. Any reply to this message is not guaranteed to be secure. Please bear this in mind when deciding whether to send material by e-mail in response to this message. When you do send such information to us, we recommend that you send it by facsimile, mail, or tell us over the telephone.