



#17-136: Villas at Old Hawthorne Plat 1F Final Plat



Roads	
	100-Year Floodplain
	Scenic Route
	U-C Benton Stephens Urban Conservation District



Created by The City of Columbia - Community Development Department







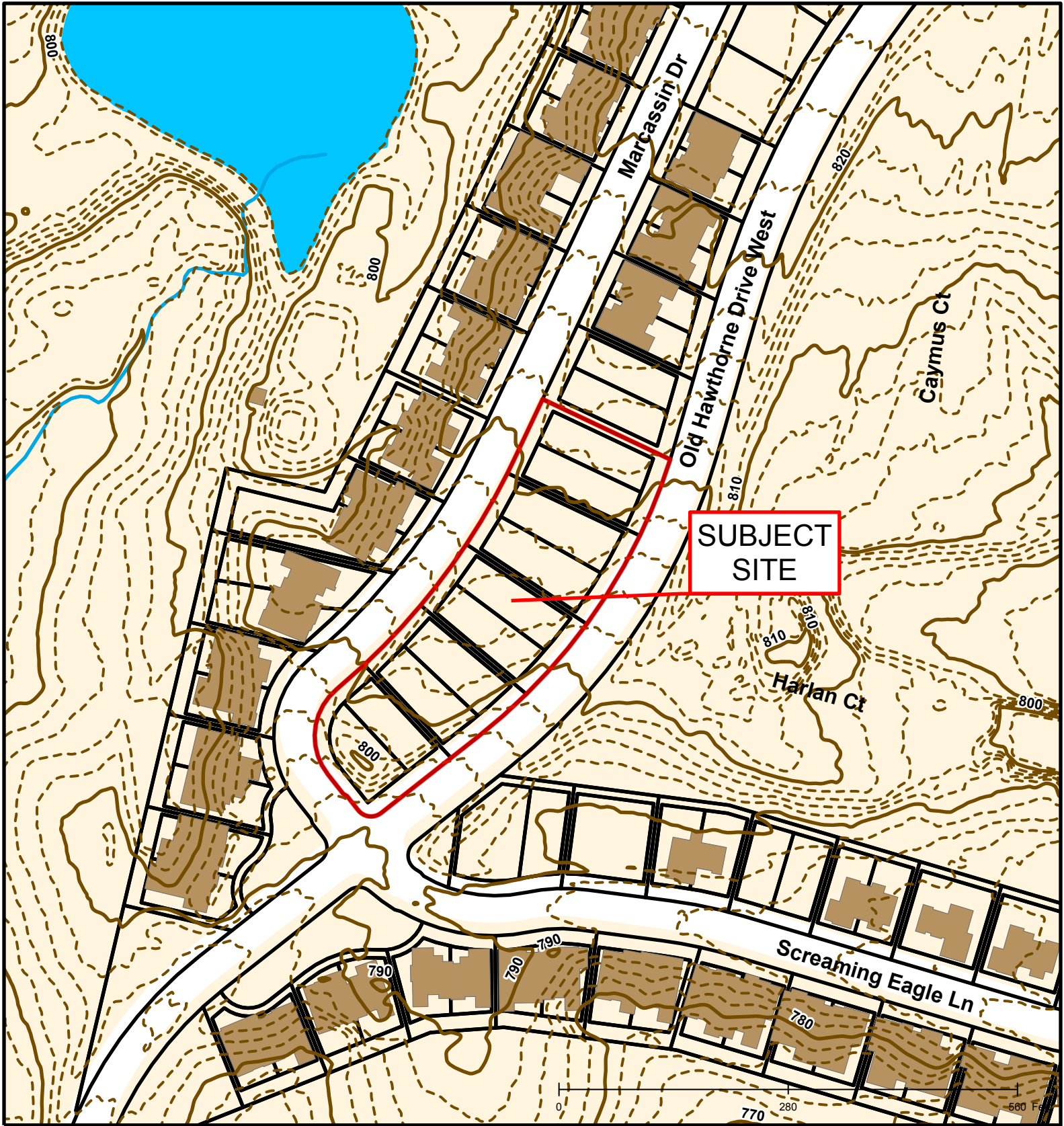

Parcel Data Source: Boone County Assessor

2015 Imagery: Boone County Assessor's Office

Hillshade Data: Boone County GIS Office



#17-136: Villas at Old Hawthorne Plat 1F Final Plat

	Roads		2 Foot Contour Lines		Stream
	Building Footprint		100-Year Flood Plain		Streams
	10 Foot Contour Lines		Parcels		Bodies of Water





**#17-136: Villas at Old Hawthorne Plat 1F
Final Plat**



BCRSD	Roads
City Sanitary Structure	BCRSD
Private Sanitary Structure	City Sanitary Line
UMC	Private Sanitary Line

